

REV	RESP	ENG	RELEASE	REVISION RECORD	
A	WHO				

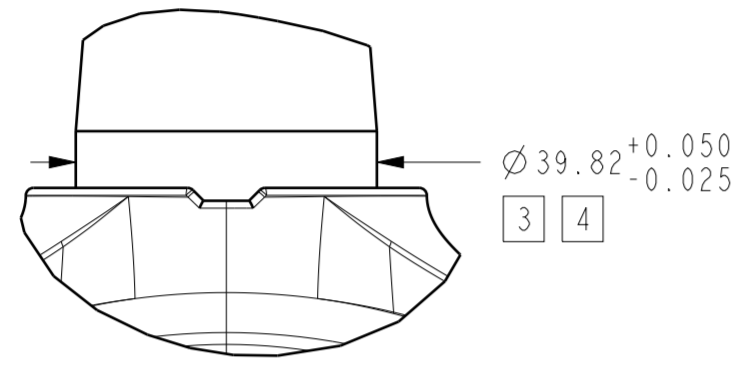

DETAIL Z
SCALE 1.000

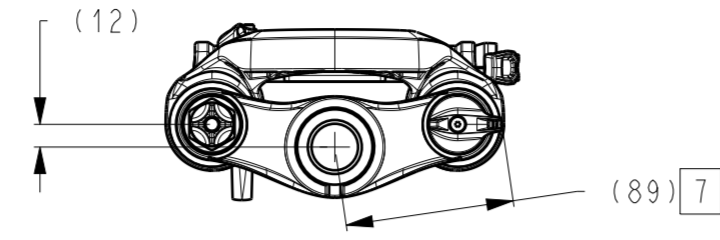
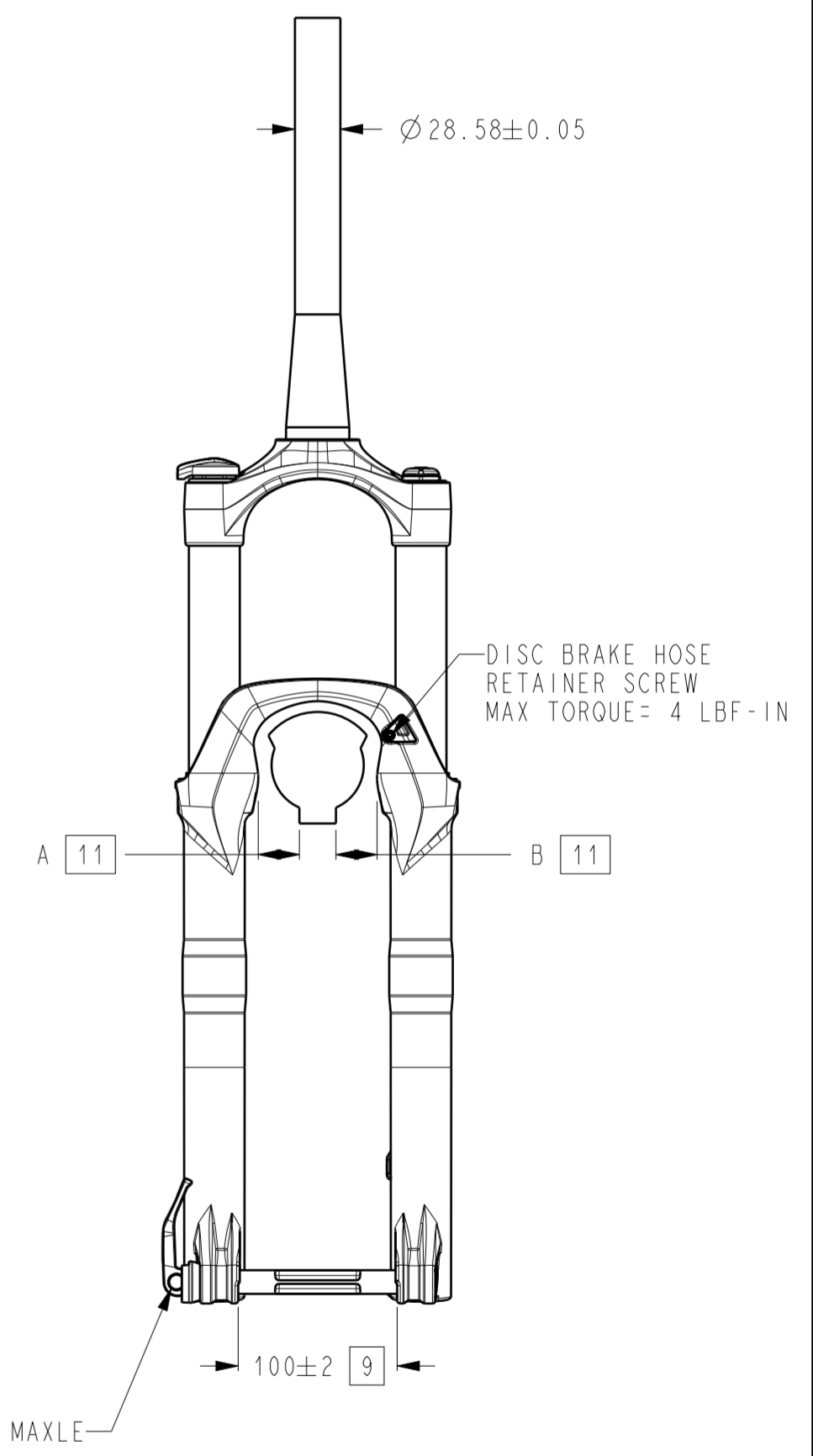
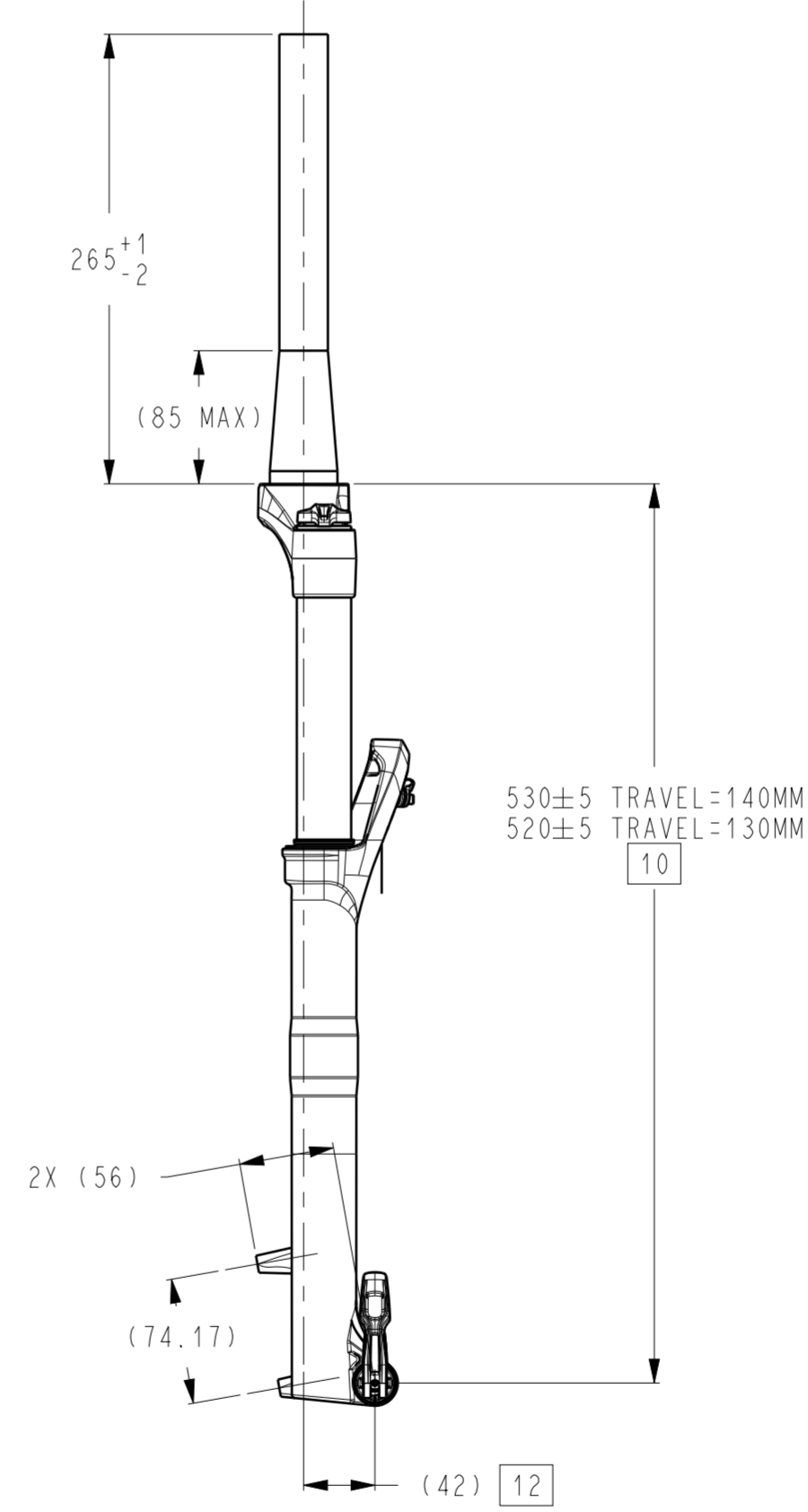
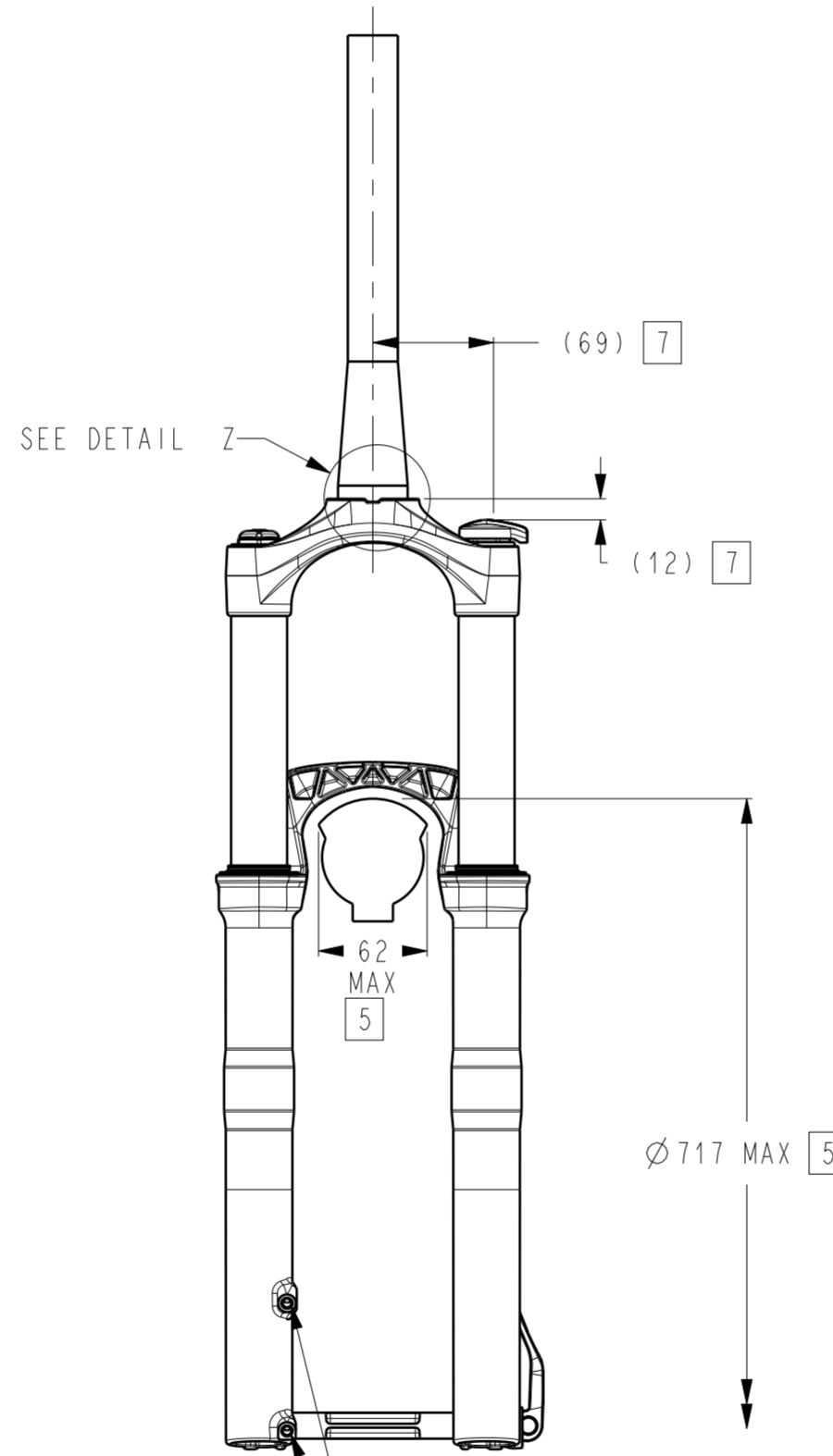

M6X1-6H ∇ 14 MIN
BRAKE CALIPER BOLT RECOMMENDED
FULL THREAD ENGAGEMENT = 9-12MM
MAX TORQUE = 90 LBF-IN (10.2 N-M)
6

NOTES: (UNLESS OTHERWISE SPECIFIED)

- SRAM RESERVES THE RIGHT TO CHANGE SPECIFICATIONS WITHOUT PRIOR NOTICE.
- REFERENCE DIMENSIONS NOTED WITH "()" ARE FOR CUSTOMER DESIGN INFORMATION ONLY.
- CROWN RACE OD MEASURED AS AVERAGE OF 3 DIAMETRIC POINTS MINIMUM.
- HEADSET CUP ID MUST BE GREATER THAN STEER TUBE OD +0.3MM.
- IMPORTANT: CUSTOMER IS RESPONSIBLE FOR ENSURING MINIMUM TIRE CLEARANCE. DO NOT EXCEED MAXIMUM TIRE ENVELOPE INDICATED ON THIS DRAWING.
- POST TYPE BRAKE CALIPER MOUNT, DIRECT FOR 160MM ROTOR DIA. MAX ROTOR DIA = 215MM.
- FORK / FRAME CLEARANCE (WORST CASE)
- 3D REPRESENTATION FILES (.IGS AND .STP) AVAILABLE UPON REQUEST.
- IMPORTANT: CUSTOMER IS RESPONSIBLE FOR ENSURING THAT ROCKSHOX MAXLE SYSTEM IS USED PER SRAM'S OPERATING INSTRUCTIONS
- CROWN RACE TO AXLE DISTANCE SHOWN BASED ON:
- MEDIUM SPRING, MIN PRELOAD (FOR FIXED COIL)
- 100 PSI (FOR SOLO AIR)
- WHEEL CENTER TOLERANCE: $|A-B| < 2\text{MM}$
DISHED WHEEL OR GAGED MUST BE CLAMPED IN DORPOUTS.
- DIMENSION IS PERPENDICULAR OFFSET FROM STEERER TUBE AXIS TO DROP OUT CENTER (TOTAL OFFSET).

ALL DIMENSIONS ARE mm

THIRD ANGLE PROJECTION

MASS (g) N/A

MATERIAL N/A

GEOMETRIC DIMENSIONING AND TOLERANCING TO BE INTERPRETED PER ASME Y14.5-2009

UNTOLEANCED LENGTH DIMENSIONS (mm)

LENGTH DIMENSIONS	TOLERANCE
from 0.5 up to 6	± 0.1
over 6 up to 30	± 0.2
over 30 up to 120	± 0.3
over 120 up to 400	± 0.5
UNTOLEANCED ANGLE DIMENSIONS	$\pm 2'$

FORMAT: A2	SCALE: 0.25	SHEET: 1 / 1
LIFECYCLE STATUS		<p>SRAM</p> <p>CONFIDENTIAL - THIS DRAWING CONTAINS INFORMATION THAT IS PROPRIETARY TO SRAM CORPORATION AND MAY NOT BE DISCLOSED WITHOUT PERMISSION.</p>
In Work		
DRAWING NAME / DESCRIPTION		
USER SPEC RCN 2715 TPR 130/140		
DRAWING NUMBER		VERSION
98-4015-113-000		A.1