

# Frame Fit Specifications

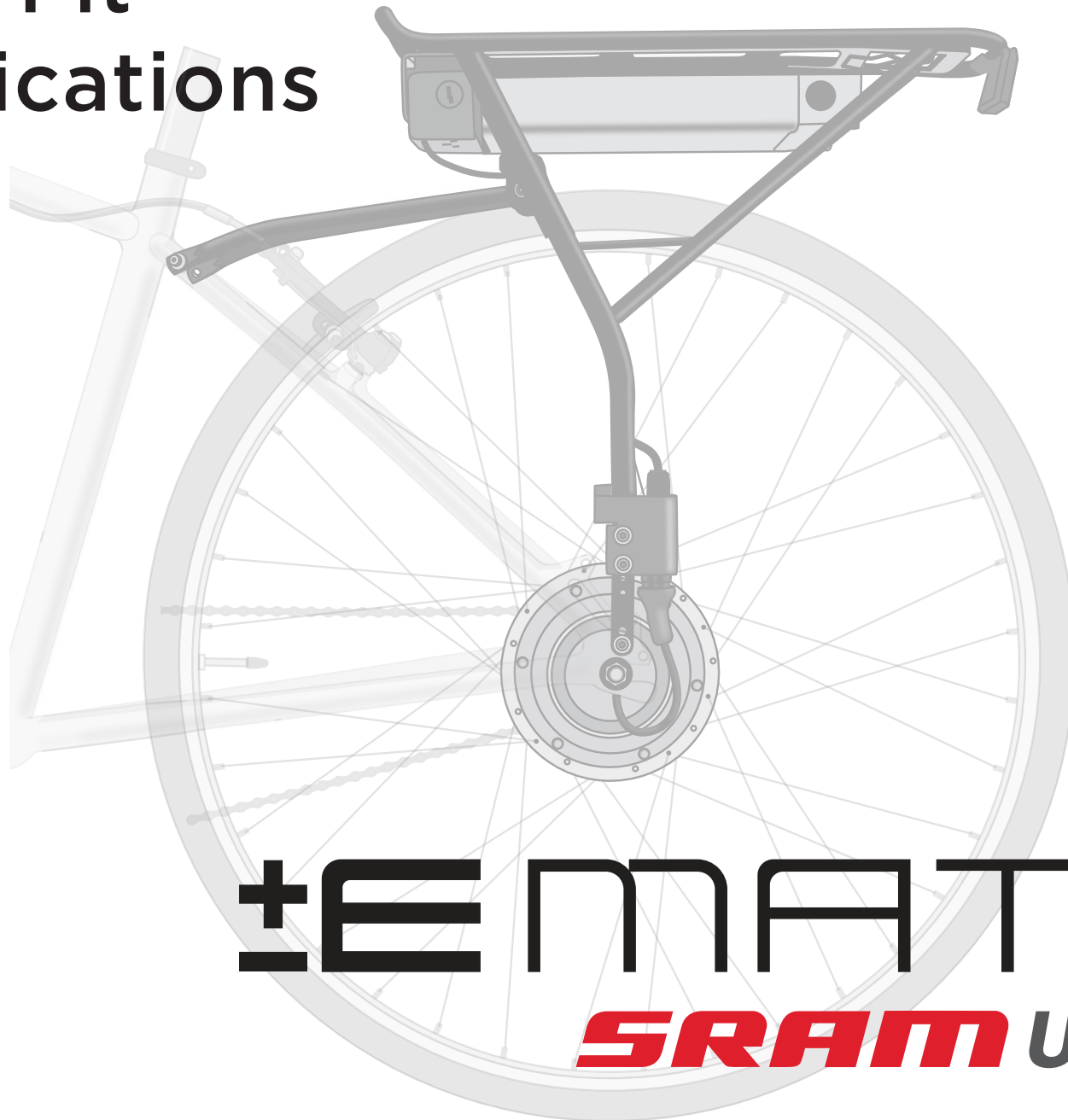

**±E N M A T I C**  
**SRAM** URBAN

## HUB

All dimensions in millimeters unless otherwise indicated - drawings not to scale

### Hub Motor Specifications

Motor Type : Brushless

Rated Power : 250 Watts

Maximum Torque Output : 55 N·m

Maximum Assisted Speed : 20 mph or 25 kph (model dependant)

Weight : 4.5 kg (9.9 lb)

Position : Rear wheel

### Additional Specifications and Dimensions

Rear Spacing : 135 mm OLD

Hubshell Diameter : 159 mm

Hubshell Width : 107 mm

Spoke Circle Diameter : 148 mm

Spoke Hole Diameter : 3 mm

Distance to Center of Flanges (from Hub Center) : 28.3 mm

Axle Length : 183 mm

Axle Thread : M10 x 1

Chainline : 53 mm

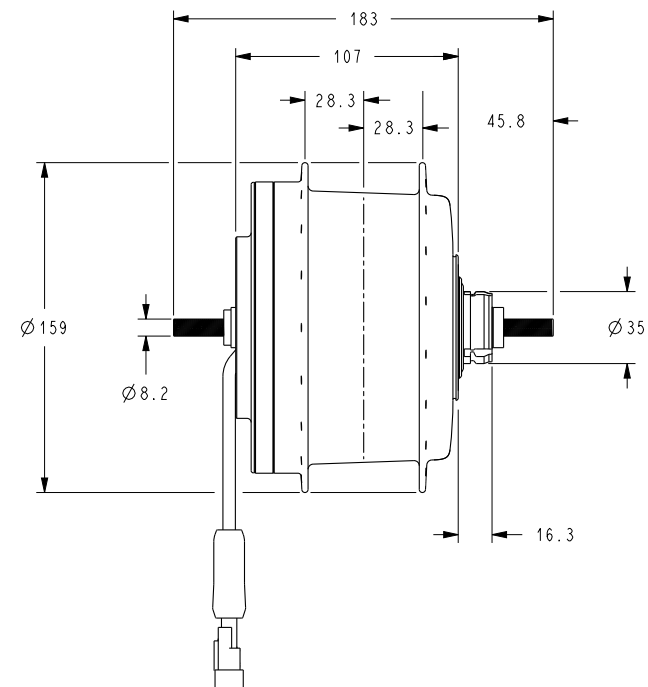
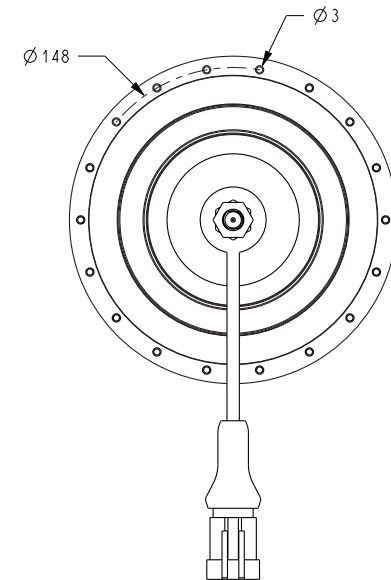

## H U B

## Fitment and Frame Requirements

Dropouts : Horizontal, sliding, or vertical - *vertical dropouts require the use of a chain tensioner*

Dropout width : 10 mm maximum

Wheel Size : 20", 26", 28", or 700 c

Spoke Holes : 32 or 36

Spoke Lacing : Tension to approximately 100 kg-force (1000N)

Front Chainring : 42t, 44t, or 46t - *recommended gearing 44t/17t (2.59 gear ratio)*

Rear Sprocket : 17t, 18t, 19t, 20t, or 21t

Chain : Single speed recommended

Chain Guard : Compatible

Rear Brake : Rim or Disc - *disc brakes require SRAM specific 190 mm rotor with OE designed and sourced caliper adapter bracket. Refer to the "Hub/Disc Brake Mount section on the next page for an example.*

## HUB/DISC BRAKE MOUNT - EXAMPLE

All dimensions in millimeters unless otherwise indicated - drawings not to scale

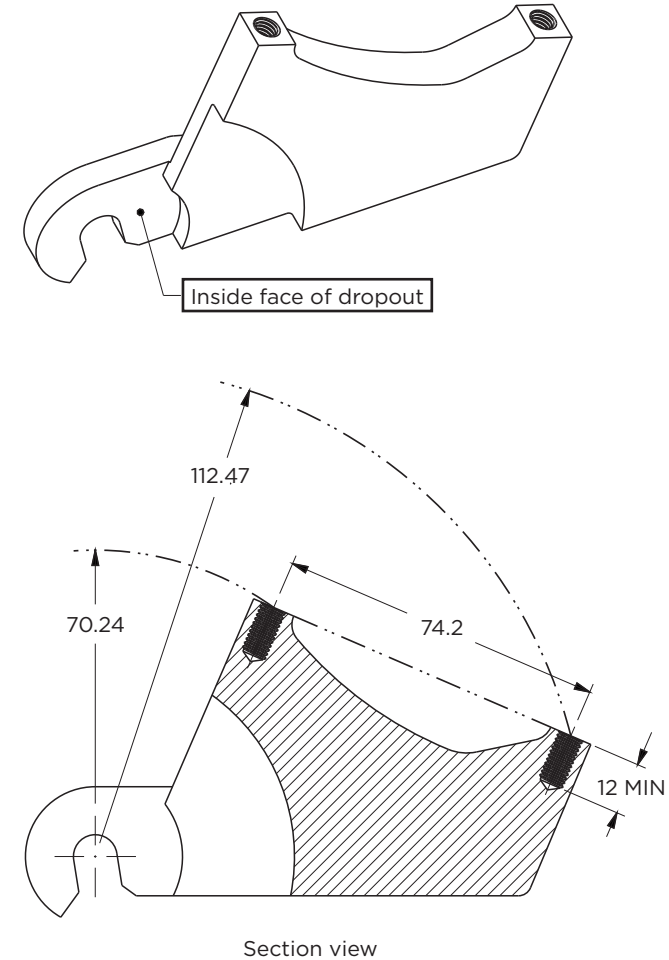
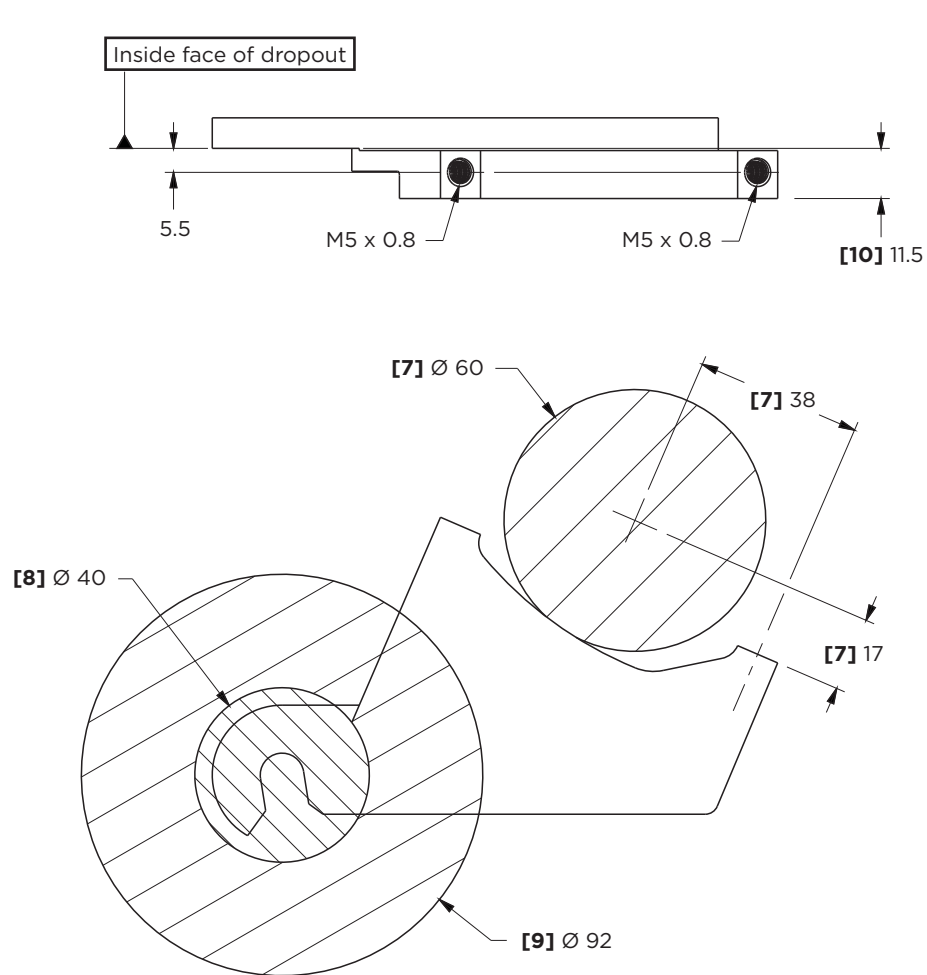

### NOTES

1. This is an example of an adapter bracket design, this part is **NOT** available from SRAM.
2. Brake caliper adapter mount must be designed and sourced by the OE to fit their frame.
3. All dimensions in millimeters unless otherwise specified.
4. All dimensions for use with direct mount 190 mm rotor.
5. Check fit with Avid caliper and rotor.
6. 135 mm OLD required.
7. Spoke heads are located 37 mm inward from inside face of dropout at a diameter of 147 mm.
- [8] Caliper clearance.
- [9] Keep Out for hub. Begins at inside face of dropout
- [10] Keep Out for hub. Begins 5.0 mm inward from inside face of dropout.
- [11] Max thickness of dropout/adapter measured from inside face of dropout.

**ROTOR**

All dimensions in millimeters unless otherwise indicated - drawings not to scale

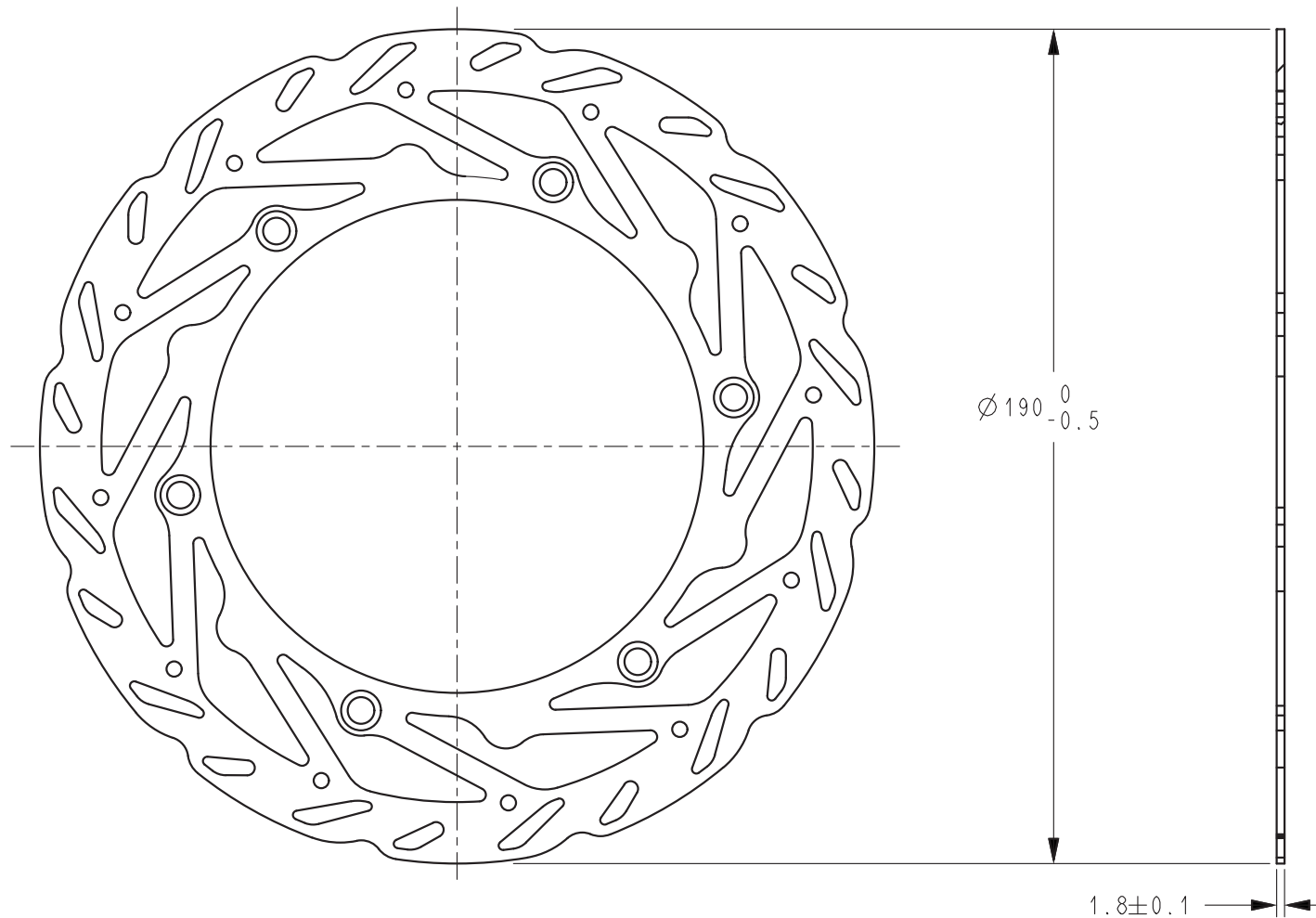
**NOTES**

1. This is a custom rotor due to the size and bolt-circle diameter, and is only available from SRAM.

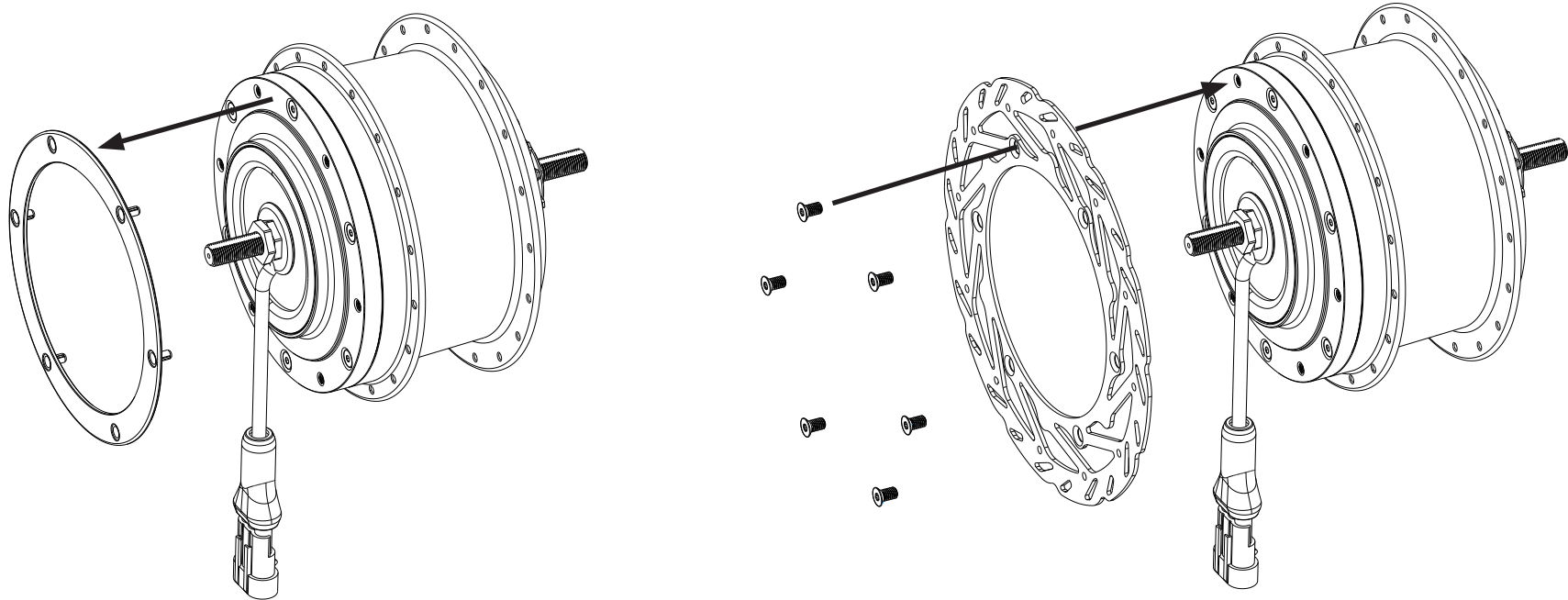
**ROTOR INSTALLATION****NOTES**

1. All hubs will ship with a disc brake rotor blank.
2. Pry the rotor blank from the hub. Be careful not to scratch the hub face.
3. Remove all grease from the hub face.
4. To install the rotor, align the bolt holes in the rotor with the bolt holes in the hub, then use a T15 TORX® wrench to install and tighten the rotor bolts to 6.2 N·m (55 in-lb).

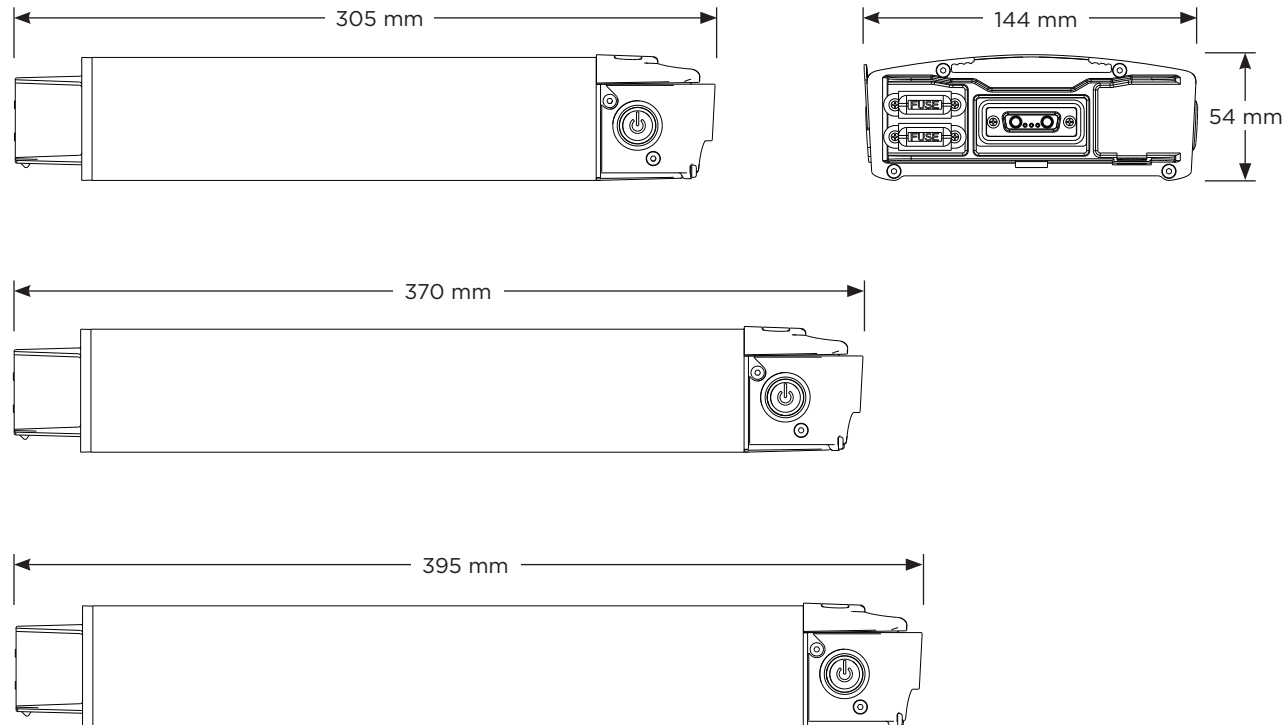
**BATTERY PACK**

**Battery**

Battery Size	Voltage	Distance*	Charge Time (approximate)	Cell Type	Weight
9.7 Ah/350 Wh	36.2 V	50-95 km (31-59 miles)	4.25 hrs	Samsung Lithium-Ion	3.3 kg (7.2 lb)
7.7 Ah/280 Wh		40-80 km (25-50 miles)	3.5 hrs		2.8 kg (6.1 lb)
5.8 Ah/210 Wh		30-60 km (19-37 miles)	2.5 hrs		2.2 kg (4.9 lb)

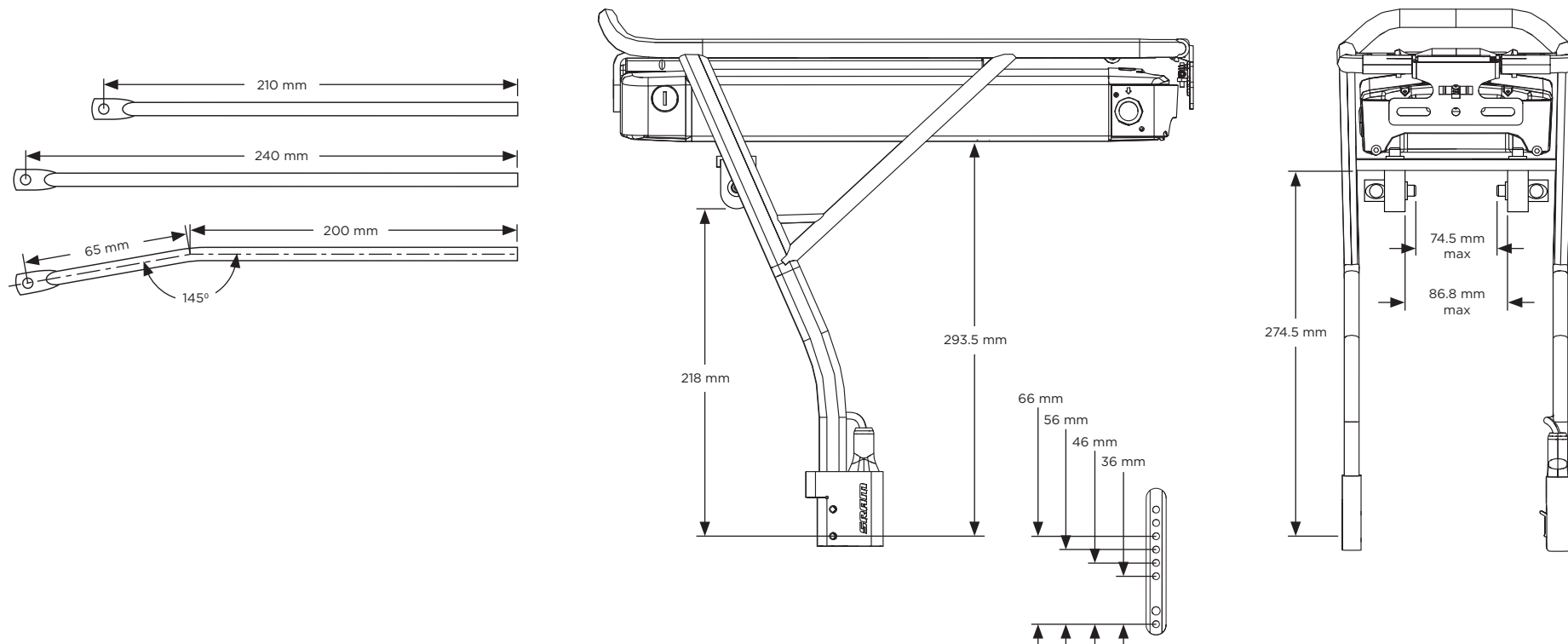
\*Distance is dependent on conditions & terrain.

**RACK**

**Rack**

Weight (not including frame bolts or battery) : 1.9 kg (4.25 lbs)

Max Load : 25 kg (55 lb)

**NOTES**

1. OE may design and supply custom rack to use with SRAM battery packs, or may work with SRAM battery supplier to develop and supply custom battery pack and rack.
2. All 3 battery pack sizes use the same rack.
3. Rack mounts on back of bike on standard frame - attaches to dropouts & seat-stay mounts.
4. OE can develop & supply battery pack and rack by working with SRAM battery supplier.



This publication includes trademarks and registered trademarks of the following companies:  
TORX® is a registered trademark of Acument Intellectual Properties, LLC



[www.sram.com](http://www.sram.com)